



SKYLINE

BUILDING YOUR DREAM HOME

GIVING *Life*  
A NEW *Meaning*

SKYLINE ENCLAVE

Waliv, Vasai East



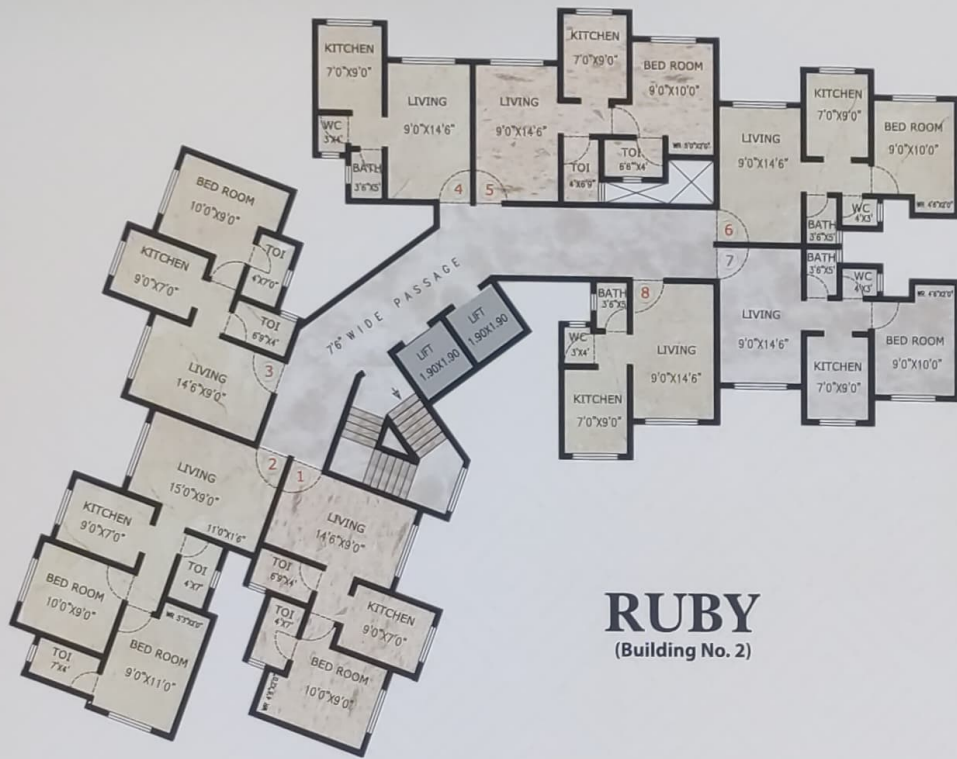

**1RK**



**1BHK**



**1BHK (M. Bed)**



**2BHK**



*Welcome to the Gems of Skyline*

*At Skyline Realtors  
We believe that superior quality  
shouldn't be Expensive*

RUBY

PEARL

SKYLINE



# AMENITIES

## COMMON AMENITIES

- **BRANDED ELEVATORS WITH POWER BACKUP IN EACH WING**
- **GRAND ENTRY LOBBY**
- **CHILDREN'S PLAY AREA**
- **GARDEN**
- **CCTV SURVEILLANCE**
- **AMPLE PARKING AREA**
- **MUNICIPAL WATER CONNECTION**
- **ELEGANT ENTRY GATE**
- **SECURITY CABIN**



## LIVING ROOM & BED ROOM

- POP False Ceiling
- Vitrified Flooring Tiles
- Attractive Main Door with Laminated and Brass Fitting
- Branded Paint on Interior walls
- Powder Coating Aluminium Sliding Windows
- Mosquito Nets in Living Room
- Granite Window Frames

ELECTRICAL POINTS ONLY  
(Modular Switches with Concealed Wiring)

PARTICULARS	LIVING ROOM	BED ROOM	MASTER BED
Spot Light	4	2	2
Fan	1	1	1
Chandelier	1		
Television	1	1	1
Air conditioner		1	1
Lantern	1	1	1
Plug Point	2	2	2
Bell Point	1		
Tube Light	1	1	1



## KITCHEN

- Modular kitchen stainless steel trolleys
- Glazed tiles on walls
- Granite window frame
- Granite platform with stainless steel sink

ELECTRICAL POINTS ONLY  
(Modular Switches with Concealed Wiring)

Refrigerator	1	Exhaust Fan	1
Mixer	1	Water Purifier	1
Fan	1	Plug Point	1
Light	1	Oven	1
Washing machine			1

PLUMBING POINTS  
(Branded Concealed Fittings)

Water Purifier	1
Washing Machine	1
Sink Tap	1



## BATHROOMS

- Granite Door Frame
- Branded Sanitaryware Fittings
- Loft in Bathroom
- Inverter Point in Bathroom Loft
- Granite window sill with Louvers

ELECTRICAL POINTS ONLY  
(Modular Switches with Concealed Wiring)

Light	1	Geysers	1
Plug Point	1	Exhaust Fan	1

PLUMBING POINTS  
(Branded Concealed Fittings)

Mixer	1	Wash Basin	1
Geysers	1	Shower	1





**Builders & Developers**  
**SKYLINE REALTORS**

**Site Address :**

Skyline Enclave  
Near Axis Bank ATM,  
Khairpada, Waliv  
Vasai (East) - 401 208

**Office Address :**

Anant Group of Companies  
1, Shivani, Opp. DCB Bank,  
Ambadi Road, Vasai Road (W),  
Dist. Palghar - 401 202

E-mail : [skylinesales101@gmail.com](mailto:skylinesales101@gmail.com)

**For Sale Enquiry Call :** 8600 3700 48  
8600 3700 49



**RERA NO. P99000031239**



Architectural Consultants & Urban Planner  
**HIMESH GUPTA & ASSOCIATES**

RCC Consultants  
**SEEMU CONSULTANCY,**

Legal Advisor  
**K. A. Sanghavi & Associates , Vasai**  
Anish Kalvert, Vasai

Architectural Designers  
**KEA Design, Malad**  
Dream Modeling, Virar

ALL PAYMENTS TO BE MADE IN THE FAVOUR OF  
**"SKYLINE REALTORS"**

FOLLOW US ON   

Disclaimer: All the plans, designs, images, specifications, dimensions, facilities and other details herein are purely indicative in nature and the intended recipient should note that these are to be treated as purely provisional and informative and as such only tentative subject to the approval from respective authorities. We reserve the right to modify/ change/ amend/ alter any of the aforesaid in the best interest of the development without prior intimation/ notice and without any obligation. The content herein should not be construed as an offer/ invitation to offer/ contract. Any party desirous/ interested in the project need to enter in to Agreement of Sale and its development/ transaction shall be governed by the terms and conditions of the Agreement of Sale. The printed material inter alia images, contents therein is for representative purpose only.