

SRI KALKI REAL ESTATE.
ANJANADRINAGAR

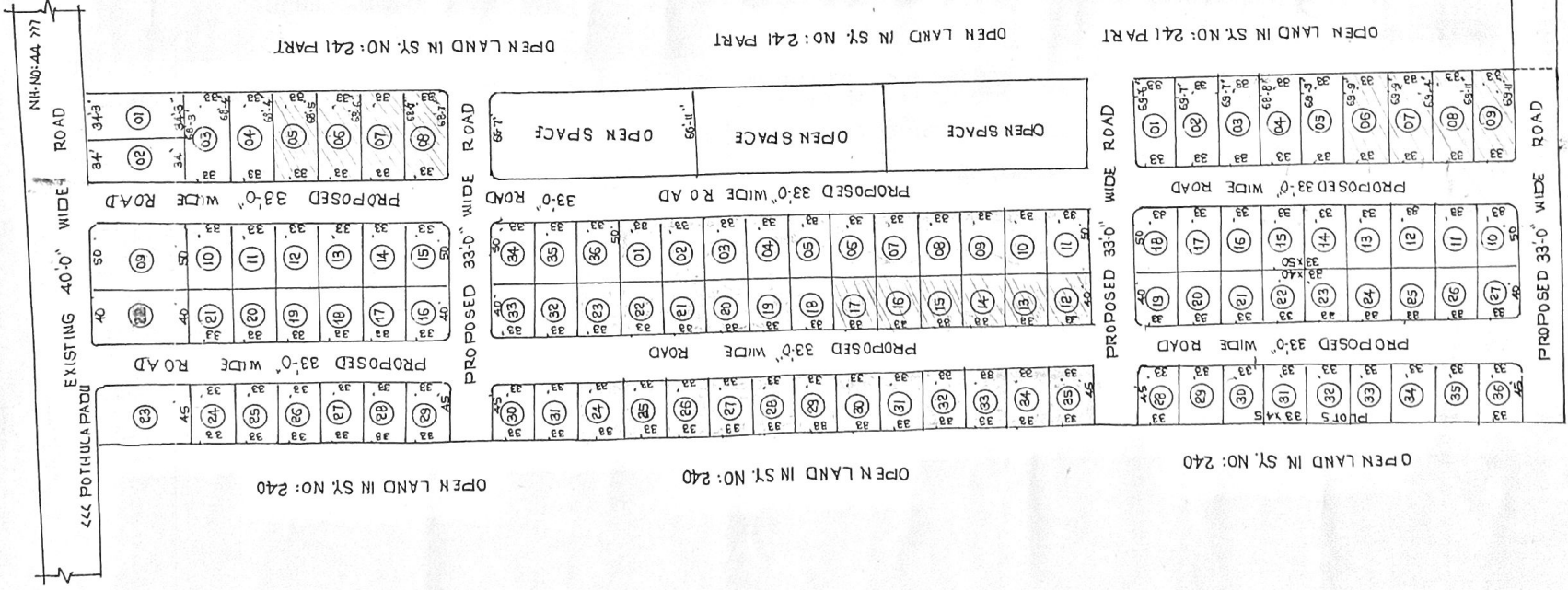

REFERENCE:
LAYOUT BOUNDARY :
EXISTING ROADS :
PROPOSED ROADS :
MORTGAGE AREA :

BLOCK C
D.T. L.P. NO: 32 / 2021 / DTCPO / GDWL
C. NO: 65 / 2021 / DTCPO / GADWAL
E- PANCHAYATH ONLINE 2344 / 2021 OF P.S. PULLUR

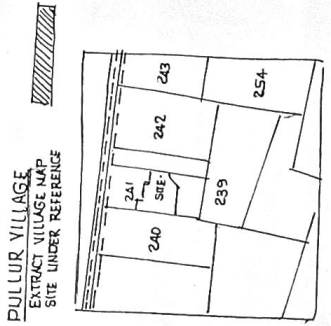

BLOCK " B "
D.T. L.P. NO: 43 / 2021 / DTCPO / GDWL
C. NO: 67 / 2021 / DTCPO / GADWAL
E- PANCHAYAT ON LINE 2369 / 2021 OF P.S. PULLUR

BLOCK " A "
D.T. L.P. NO: 33 / 2021 / DTCPO / GDWL
C. NO: 66 / 2021 / DTCPO / GDWL
E- PANCHAYAT ON LINE 2368 / 2021 OF P.S. PULLUR

PULLUR GRAMPANCHAYAT
DRAFT TECHNICAL LAYOUT PATTERN FOR RESIDENTIAL
PLOTS IN SY. NOS. 241/P SITE 'C', SITE 'B' IN SY. NO: 241/P SITE 'A'
SY. NO: 241/A2, 241/A3 & 241/A1, SITUATED AT PULLUR
VILLAGE UNDAVELLY MARDAL JOGULAMBA GADWAL DIST.

DRAWN BY

ABDUL AZEEM
Municipal Engineer, Surveyor
GADWAL Municipality.