



# ACUTE ENGITECH

AN ISO 9001 COMPANY

**A ONE-STOP INSTRUMENTATION SOLUTION**

[www.acuteengitech.com](http://www.acuteengitech.com)

# CONTENT

<b>1</b>	<b>ABOUT US</b>	<b>1</b>
<b>2</b>	<b>PRESSURE &amp; TEMPERATURE GAUGE PARTS :</b>	<b>2</b>
(A)	• <b>STAINLESS STEEL CASE</b>	<b>2</b>
(B)	• <b>GLASS FOR PRESSURE &amp; TEMPERATURE GAUGE</b>	<b>4</b>
(C)	• <b>OTHER PARTS &amp; CASING ACCESSORIES</b>	<b>4</b>
(D)	• <b>PHENOLIC &amp; SOLID FRONT CASING KIT</b>	<b>5</b>
(E)	• <b>BOURDON TUBE</b>	<b>6</b>
(F)	• <b>SOCKET FOR PRESSURE GAUGE</b>	<b>8</b>
(G)	• <b>READY TO ASSEMBLE PRESSURE GAUGE KIT</b>	<b>10</b>
<b>3</b>	<b>METAL TRAY FOR PHARMACEUTICAL DRYER MACHINE</b>	<b>11</b>
<b>4</b>	<b>STAINLESS STEEL CASE FOR CHART RECORDERS</b>	<b>11</b>
<b>5</b>	<b>PRECISION SHEET METAL COMPONENTS (PRESS-PARTS)</b>	<b>11</b>
<b>6</b>	<b>STAINLESS STEEL FLEXIBLE CONDUIT</b>	<b>12</b>
<b>7</b>	<b>STAINLESS STEEL CAPILLARY</b>	<b>14</b>
<b>8</b>	<b>STAINLESS STEEL MICROBORE CAPILLARY</b>	<b>15</b>
<b>9</b>	<b>SMALL DIAMETER PRECISION TUBES</b>	<b>16</b>
<b>10</b>	<b>PRESSURE GAUGE ACCESSORIES</b>	<b>18</b>
<b>11</b>	<b>INSTRUMENTATION VALVES &amp; MANIFOLDS :</b>	<b>19</b>
(A)	• <b>2 VALVE MANIFOLD</b>	<b>19</b>
(B)	• <b>3 VALVE MANIFOLD</b>	<b>20</b>
(C)	• <b>5 VALVE MANIFOLD</b>	<b>21</b>
(D)	• <b>OTHER VALVES &amp; MANIFOLDS</b>	<b>22</b>
<b>12</b>	<b>TEMPERATURE SENSOR PARTS :</b>	<b>23</b>
(A)	• <b>THERMOWELL</b>	<b>23</b>
(B)	• <b>NIPPLE UNION NIPPLE CONNECTORS</b>	<b>25</b>
<b>13</b>	<b>FITTINGS :</b>	<b>26</b>
(A)	• <b>ADJUSTABLE COMPRESSION FITTINGS</b>	<b>26</b>
(B)	• <b>SPECIAL FITTINGS FOR DIAPHRAGM SEALS</b>	<b>26</b>
<b>14</b>	<b>TUBE FITTINGS</b>	<b>27</b>
<b>15</b>	<b>INDUSTRIAL GLASS THERMOMETER</b>	<b>29</b>

# THINK INSTRUMENTATION THINK ACUTE.

## ABOUT US

### QUALITY. PRECISION. RELIABILITY.

Acute Engitech is an ISO 9001 manufacturing company serving as a one-stop solution to the Instrumentation Industry.

Located in Maharashtra, India our wide product portfolio includes Pressure Gauge Parts & Components, Precision Instrumentation Tubes, Instrumentation Valves & Manifolds, Coiled Capillary & Micro-Fine Capillary Tubes, Flexible Protection Conduit, Safety & Toughened Glass, Pressure Gauge & Sensor Accessories and Instrumentation Fittings.

Owing to a very humble beginning, Acute Engitech scaled up its operations globally serving companies spread across 20 countries. The reliability of our products has been a key factor to achieve a leading position in global markets.

Our manufacturing units are well-equipped with modern facilities, advance technology, in-house testing facilities and a team of technically sound & quality engineers in order to deliver industry-specific & tailor-made requirements. This capability allow us the flexibility to serve diverse field of industries.

Our customers enjoy a key advantage of maintaining their overall product quality and maintaining quality of critical joints by procuring all of their manufacturing requirements from one roof. We offer an unmatched advantage of being a one-point procurement destination for our customers.

Our ability to meet tailor-made client requirements & delivery schedules and our desire for innovation has helped our brand “**Acute Engitech**” to be a preferred brand for many reputed OEM’s, trading houses & end-users globally.

Constantly evolving in technology and automation has been an integral part of our work culture. Having an experience of over decades, our service also offers assistance for selection of right products for suitable application. We have been providing an innovative & leading concept to the market we serve.

# WE HAVE THE RIGHT PARTS FOR YOUR PRESSURE GAUGE

## PRESSURE & TEMPERATURE GAUGE PARTS STAINLESS STEEL CASE

INDIA'S FIRST MANUFACTURER OF STAINLESS STEEL CASING FOR PRESSURE GAUGE INDUSTRY



**GRADE :** Stainless Steel 304 , 304 L , 316 or 316 L

**DIAL SIZE :** 1 ½" (40mm) , 2" (50mm) , 2 ½" (60mm - 63mm) , 3" (75mm - 78mm) , 4" (96mm - 100mm) , 4.5" (115mm) , 6" (148mm - 150mm - 151mm) , 8" (200mm) , 10" (250mm) or 12" (300mm)

**TYPE :** Bayonet Type , Crimping Type, Press Fit Type or DIN Type

**CONNECTION HOLE :** Bottom Connection or Back Connection

**CONNECTION HOLE SHAPE :** Round or Square

**FINISH :** Natural , Mirror , Matte or Combination

## DESCRIPTION

---

We manufacture **Stainless Steel Case** for Pressure Gauge Body & various other Measuring Instrument Body. Our entire range is available in different designs and sizes to meet the different industry needs. The offered products are broadly appreciated for compact design, corrosion resistance, impact resistance and durability.

## SPECIAL FEATURES

---

- CAN BE MANUFACTURED AS PER DRAWINGS, TAILOR-MADE AS PER SPECIFIC REQUIREMENT
- POSSESS 1000+ MOULDS, DESIGNS, STYLE, SIZES & COMBINATION

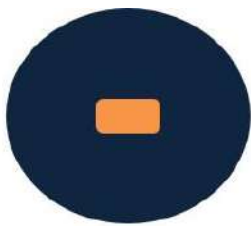

BACK CONNECTION



BOTTOM CONNECTION



SQUARE HOLE



ROUND HOLE

- AVAILABLE WITH GLYCERIN FILLING HOLE & SAFETY-EXPLOSION PROOF HOLE (OPTIONAL)
- AVAILABLE WITH COMPATIBLE RUBBER PARTS & RUBBER 'O' RING FOR GLASS FITTING (OPTIONAL)
- COMPLETE RANGE OF **DIN TYPE CASING** AVAILABLE



## GLASS

PRESSURE GAUGE . TEMPERATURE GAUGE



- **TYPE** : Laminated Safety Glass , Toughened (Tempered) Glass, Polycarbonate Glass or Acrylic Glass
- **DIAL SIZE** : 40mm to 250mm
- **THICKNESS** : 3mm or 4mm
- **COMMON SIZES** : 58mm , 66mm , 66.5mm , 99mm , 101mm , 105mm , 106mm , 107mm , 108mm , 114mm , 133mm , 136mm , 145mm , 151mm , 153mm , 156mm , 158mm & 161mm
- **CAN BE MANUFACTURED AS PER DRAWINGS (TAILOR-MADE AS PER SPECIFIC REQUIREMENT)**

## OTHER PARTS & CASING ACCESSORIES

PRESSURE GAUGE . TEMPERATURE GAUGE



RUBBER 'O' RING & RUBBER PARTS



EVERY-ANGLE BRACKET



DIAPHRAGM SEAL



PANEL & SURFACE MOUNTING PLATES



POLYCARBONATE HOOD FOR ELECTRONIC CONTACT GAUGE

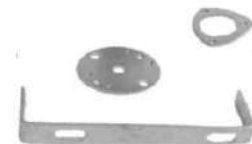

MOUNTING BRACKET & METAL SHEET PARTS

# PHENOLIC & SOLID FRONT CASING KIT

HIGH SAFETY BLOW-OUT BACK



**DIAL SIZE :** 4.5" (Standard) **COLOR :** Black

**BEZEL TYPE :** Threaded

**PLUG VENT HOLES :** 2 Holes

**CONNECTION HOLE SHAPE :** Round (Standard)

OUR COMPLETE PHENOLIC CASING KIT CONSIST OF

- CASE & BEZEL
- STAINLESS STEEL BACK PLATE
- RUBBER DISK *for* BACK PLATE
- RUBBER 'O' RING *for* SOCKET
- SUITABLE WHITE ALUMINUM DIAL
- SUITABLE SAFETY GLASS
- RUBBER 'O'RING FOR GLASS FITTING
- RUBBER PARTS *for* PLUG VENT

ALSO AVAILABLE WITH MONEL 400 BOURDON & SOCKET



**MOC :** Stainless Steel 304 , 304 L , 316 or 316 L

**DIAL SIZE :** 4" or 6" **TYPE :** Bayonet Type

**CONNECTION HOLE :** Bottom

**CONNECTION HOLE SHAPE :** Round or Square

**FINISH :** Natural , Mirror , Matte or Combination

OUR COMPLETE SOLID FRONT CASING KIT CONSIST OF

- CASE & BEZEL
- STAINLESS STEEL FRONT PLATE
- STAINLESS STEEL BACK PLATE
- RUBBER DISK *for* BACK PLATE
- SUITABLE WHITE ALUMINUM DIAL
- SUITABLE SAFETY GLASS
- RUBBER 'O'RING FOR GLASS FITTING

## DESCRIPTION

Our **Phenolic Casing Kit** are used for Gauges installed in Chemical & Petrochemical Plants with particularly aggressive environments.

Our **Solid Front Gauge Casing Kit** have been provided with a solid baffle wall & blow out back which immediately releases the pressure in the event of an accidental rupture of the sensing element.

# BOURDON TUBE

QUALITY . PRECISION . RELIABILITY

---●--- READY-MADE BOURDON ---●---



RAW TUBE MATERIAL



C TYPE BOURDON

*for VACUUM & LOW PRESSURE*



COIL TYPE BOURDON

*for HIGH PRESSURE*



SPIRAL TYPE BOURDON

*for GAS-FILLED*

**THERMOMETER & RECORDERS**

**MOC :** Stainless Steel 316 - 316 L , Phosphorous Bronze CUSN5% - CUSN8% , Alloy Monel 400 or Brass

**DIAL SIZE :** 40mm , 50mm , 63mm , 100mm , 150mm , 200mm or 250mm

**RANGE :** 0.6 BAR to 1000 BAR

**FINISH :** Natural , Mirror or Matter

**PROFILE TYPE :**



TYPE A - BIG



TYPE B - SMALL

## DESCRIPTION

We manufacture **Bourdon Tube** for Pressure & Temperature Gauge. Our entire range is available in custom design, sizes & ranges to meet the different needs.



## SPECIAL FEATURES

---



THERMAL  
TREATMENT

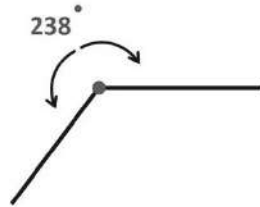

CUSTOMIZED  
INNER ARC DEGREE



LASER  
MARKING



NACE MR 0175  
MATERIAL



TAILOR-MADE AS PER  
MOVEMENT, DRAWINGS  
or CLIENT SAMPLE

- OVER 400+ DIFFERENT RAW MATERIAL TUBES MANUFACTURED SPECIFICALLY FOR BOURDON IN STOCK
- OUR BOURDON TUBES ARE REGULARLY SUBJECTED TO ENDURANCE TESTS
- OUR SPIRAL TYPE BOURDON FOR GAS-FILLED THERMOMETERS ARE SPECIALLY ARGON WELDED & MADE OF HIGH GRADE STAINLESS STEEL MATERIAL TO SUIT THE APPLICATION

# SOCKET FOR PRESSURE GAUGE



**GRADE :** Stainless Steel 304 - 316 L , Alloy Monel 400 , Alloy Inconel 600 - 800 , Hastelloy C or Brass

**DIAL SIZE :** 40mm , 50mm , 63mm , 100mm , 150mm , 200mm or 250mm

**TYPE :** Low Pressure or High Pressure

**CASE CONNECTION :** Bottom or Back

**BOURDON SLOT DESIGN :** Capsule or Milling

**LENGTH :** As Per Requirement

**THREADING :** As Per Requirement or Available Without Threading

## DESCRIPTION

---

We manufacture **Socket** for Pressure Gauge Shank Connection (Process Connection). Our entire range is available in different designs and sizes to meet the different needs.

## SPECIAL FEATURES

- ALL OUR SOCKETS ARE SUBJECTED TO ULTRASONIC CLEANING
- CAN BE MANUFACTURED AS PER DRAWINGS, TAILOR-MADE AS PER SPECIFIC REQUIREMENT
- AVAILABLE AS PER NACE MR 0175 STANDARDS

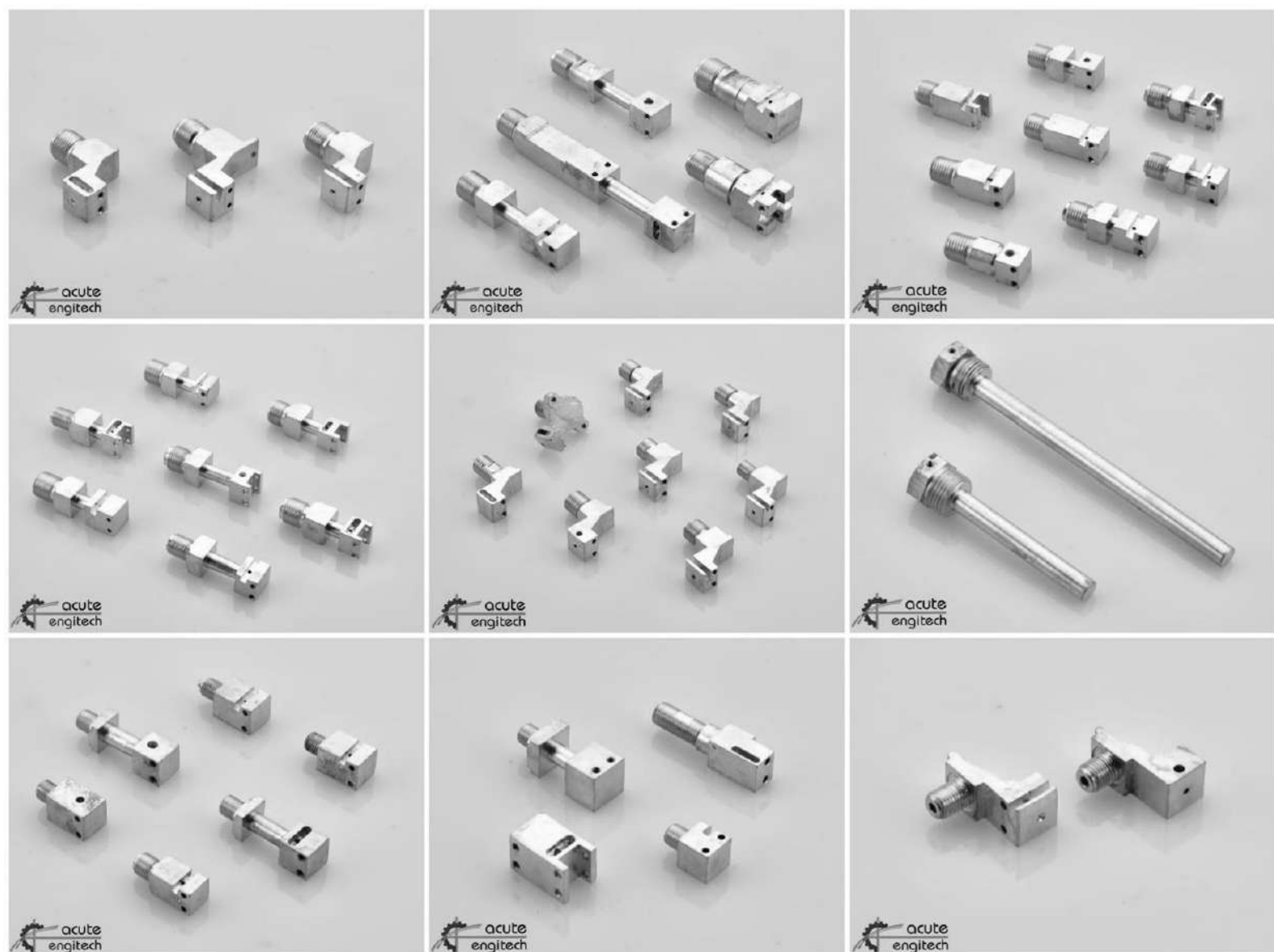

# READY TO ASSEMBLE PRESSURE GAUGE KIT

OUR INNOVATIVE & LEADING CONCEPT FOR GLOBAL MARKET

OUR READY TO ASSEMBLE PRESSURE GAUGE KIT INCLUDES :

- Stainless Steel Casing & Bezel
- Stainless Steel Socket
- Bourdon Tube
- Movement
- Tail End Piece *for* Bourdon
- Movement Fitting Screw
- Link Screw
- Dial **WITHOUT PRINTING**
- Micro Adjustable Pointer
- Stopper Pin
- Rubber 'O' Ring *for* Glass Fitting
- Rubber Parts *for* Safety Hole & Glycerin Hole
- Safety Glass **4MM THICKNESS**

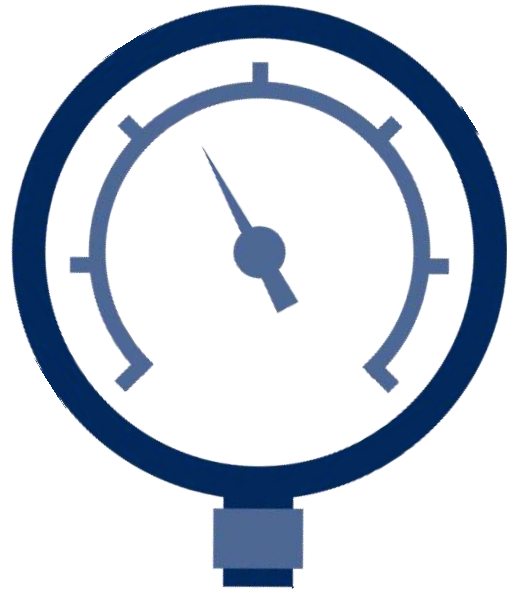

## DESCRIPTION

We have been serving our clients with our **Ready To Assemble Pressure Gauge Kit**. It helps in reducing product cost & increase total production. We have been offering assistance for selection of right products for suitable applications.

Using our Kit, clients can have complete control over assembly & calibration, hereby satisfying & adhering to local regulations.

## SPECIAL FEATURES

- **AN INNOVATIVE & LEADING CONCEPT FOR GLOBAL MARKET**
- **OUR KIT INCLUDES ALL PARTS REQUIRED TO MANUFACTURE A PRESSURE GAUGE, EVEN THE SMALLEST OF SCREW!**
- **WE HAVE BEEN OFFERING ASSISTANCE FOR SELECTION OF RIGHT PRODUCTS FOR SUITABLE APPLICATIONS**
- **ENABLES OUR CLIENTS TO FOCUS ON OTHER CORE ACTIVITIES OF ASSEMBLY, CALIBRATION, QUALITY CONTROL, SATISFYING LOCAL REGULATING BODY & MARKETING**

## METAL TRAY FOR PHARMACEUTICAL DRYER MACHINE

AIR TRAY DRYER (ATD) . VACUUM TRAY DRYER (VTD)



- MOC : 304 L or 316 L
- STANDARD SIZE : 32" x 16"
- THICKNESS : 1.2mm or 1.5mm
- SINGLE PIECE WITHOUT ANY WELD OR JOINT
- CLEAN & SMOOTH SURFACE WITHOUT ANY CONTAMINATION
- CAN BE MANUFACTURED AS PER DRAWINGS (TAILOR-MADE AS PER SPECIFIC REQUIREMENT)

## STAINLESS STEEL CASE FOR CHART RECORDERS



- MOC : 304 or 316
- DIAL SIZE : 6" (150mm), 8" (200mm), 10" (250mm) or 12" (300mm)
- FINISH : Natural , Mirror , Matte or Combination
- CAN BE MANUFACTURED AS PER DRAWINGS (TAILOR-MADE AS PER SPECIFIC REQUIREMENT)

## PRECISION SHEET METAL COMPONENTS (PRESS-PARTS)

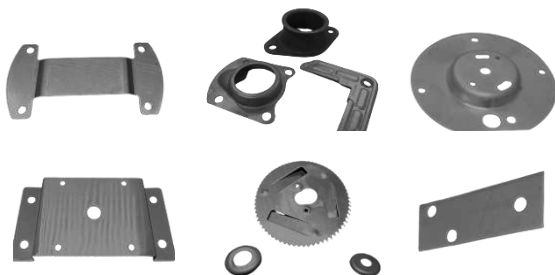

- MOC : Carbon Steel (MS), 304 or 316
- CAN BE MANUFACTURED AS PER DRAWINGS (TAILOR-MADE AS PER SPECIFIC REQUIREMENT)

# STAINLESS STEEL FLEXIBLE CONDUIT

STRENGTH . FLEXIBILITY



**GRADE :** 304 or 316

**OD SIZE :** 4mm OD to 21mm OD

## VARIANT :

### MORE FLEXIBILITY (FLEXIBILITY > STRENGTH)

This variant of our Flexible Conduit is extremely flexible wiring conduit. Its Square Lock formation allows it to conform to very small bend radius for easy positioning and harnessing. The product is designed to provide protection to power and data cables besides electric wiring in general.

### MORE STRENGTH (STRENGTH > FLEXIBILITY)

Our Double Interlock Flexible Conduit is most rugged & sturdy flexible armouring conduit available. It has fully interlocked formation i.e. adjacent strips are completely folded and locked into each other. It has remarkable strength against axial elongation, crush and bend fracture. It has moderate to high flexibility. It is most suitable for applications where extreme performance is required.

## OPTIONAL PVC COATING

**COATING THICKNESS :** 0.50mm or 1mm

**COATING COLOR :** Light Grey, Black, Blue, Red or Green

#### STANDARD SIZES

- 4mm OD x 2mm ID
- 5mm OD x 3mm ID
- 6mm OD x 4mm ID
- 7mm OD x 5mm ID
- 7.5mm OD x 5.5mm ID
- 7.8mm OD x 5.8mm ID
- 8mm OD x 6mm ID
- 8.35mm OD x 6.35mm ID
- 9mm OD x 7mm ID
- 10mm OD x 8mm ID
- 12mm OD x 10mm ID

#### DESCRIPTION

---

We manufacture heavy duty **Flexible Conduits** for various Industrial applications. It has excellent crush resistance and offers excellent protection against axial elongation. In all the types, invariably heavy gauge of strip is used making it ideal for industrial and other demanding applications.

#### SPECIAL FEATURES

---

- WE POSSESS MANUFACTURING FACILITIES TO DELIVER VARIOUS OD x ID COMBINATION AS PER REQUIREMENT
- ALSO AVAILABLE WITH PVC COATING & REQUIRED HOSE CONNECTORS
- ALSO AVAILABLE **IN RIGID STAINLESS STEEL CORRUGATED HOSE** VARIANT FOR EXTREME CONDITIONS

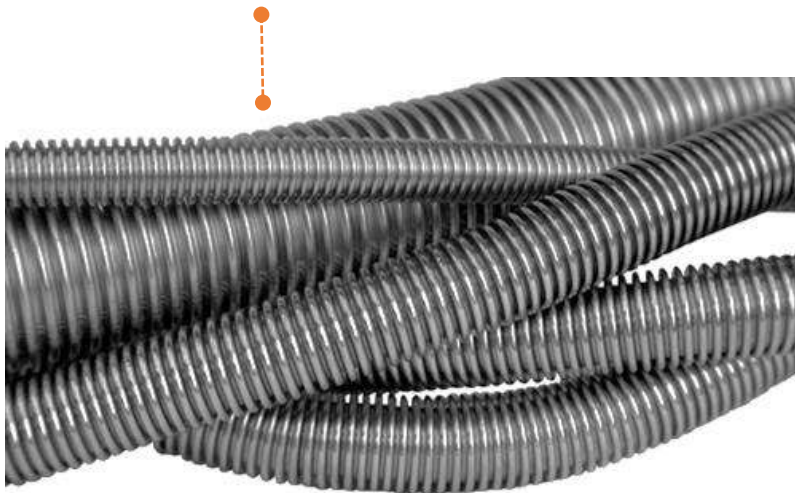

# STAINLESS STEEL CAPILLARY

ANNEALED . SOFT . BRIGHT



**GRADE :** 304 , 304 L , 316 , 316 L or 316 Ti

**OD SIZE :** 2mm OD to 12mm OD

## STANDARD SIZES

- 2mm OD x 1mm ID
- 3mm OD x 1mm ID
- 3mm OD x 2.5mm ID
- 3.18mm OD x 1.78mm ID
- 4mm OD x 2mm ID
- 4.5mm OD x 3.5mm ID
- 6mm OD x 5mm ID
- 6.35mm OD x 5.35mm ID
- 8mm OD x 7mm ID

## DESCRIPTION

---

We are one of the leading manufactures of **Stainless Steel Capillary Tubes**. Our Capillaries are made from high grade & quality raw material. They are widely known for its durability & quality. We possess manufacturing facilities to deliver various OD x ID combination in Capillary (Coil) form. This capability allow us the flexibility to serve diverse field of industries.

## SPECIAL FEATURES

---

- **AVAILABLE WITH HIGH PRESSURE NITROGEN GAS INTERNAL CLEANING OPTION**
- **OUR CAPILLARIES ARE SOFT . ANNEALED . BRIGHT**



# MICROBORE CAPILLARY

WORLD'S LEADING MANUFACTURER OF FINE PRECISION SMALL-BORE CAPILLARY

MICRO-FINE . ANNEALED . SOFT . BRIGHT



**GRADE :** 316 L or Carbon Steel (MS)

**OD SIZE :** 0.90mm OD to 3mm OD

## STANDARD SIZES

- 0.90mm OD x 0.40mm ID
- 1mm OD x 0.50mm ID
- 1.6mm OD x 0.15mm ID
- 1.8mm OD x 0.20mm ID
- 2mm OD x 0.25mm ID
- 3mm OD x 0.45mm ID

## DESCRIPTION

---

We are one of the leading manufactures of **Microfine Capillary Tubes**. Our Capillaries are made from high grade & quality raw material. They are widely known for its durability & quality. Our smallest bore serve the most critical applications across the world.

## SPECIAL FEATURES

---

- **WORLD'S LEADING MANUFACTURER OF FINE PRECISION SMALL-BORE CAPILLARY**
- **OUR MICROBORE CAPILLARIES ARE MICRO-FINE . SOFT . ANNEALED . BRIGHT**
- **SMALLEST BORE FOR CRITICAL APPLICATIONS**

# ENGINEERED TO PERFORM IN CRITICAL ENVIRONMENT TUBES TO THE TOUGHEST SPECIFICATIONS

## CUSTOM-MADE TO THE TIGHTEST TOLERANCES SMALL DIAMETER PRECISION TUBES



### SPECIAL FEATURES

- WE POSSESS MANUFACTURING FACILITIES TO DELIVER VARIOUS OD x ID COMBINATION AS PER REQUIREMENT
- THE RANGE OF OUR MANUFACTURING CAPABILITY MINIMIZES PRODUCTION LEAD TIMES IN A VERY VARIED MARKET
- WITH OUR TUBE DRAWING FACILITY & OVER 700+ DIFFERENT RAW MATERIAL TUBE READY IN STOCK, WE ARE CAPABLE OF DELIVERING CUSTOM REQUIREMENT ON SHORT NOTICE
- AVAILABLE IN ONE-END ROUNDED TUBE VARIANT
- IN-HOUSE CLEANING TO REMOVE FORMING OILS, RINSE & DRY LONG LENGTHS FOR INTRICATE PARTS
- COMPLEX CONFIGURATIONS & FINAL FINISHES (ROUGHNESS-Ra) ARE EFFICIENTLY MET BY US
- VARIOUS CUT LENGTH OPTIONS AVAILABLE (BURR-FREE) FOR CONVENIENCE IN USE & SHIPPING
- ACCLAIMED FOR FEATURES LIKE DURABILITY, LEAK PROOF, HIGH STRENGTH AND EASY INSTALLATION
- AVAILABLE AS PER NACE MR 0175 STANDARD
- AVAILABLE WITH END CAPS FOR DUST PREVENTION

**GRADE :** Stainless Steel 304 , 304 L , 310 , 316 , 316 L , 316 Ti , 321 , HRS446 , Monel 400 , Inconel 600 & 800, Hastelloy C , Titanium , Brass or Phosphorous Bronze

**OD SIZE :** 1.6mm OD to 19mm OD

**THICKNESS :** 0.20mm W.T to 3mm W.T

**STANDARD & SPECIFICATION :** ASTM A269, ASTM A213, ASTM A270, DIN 2391, EN 10216-5 GB/T14976 or GB/T13296

**HARDNESS (TEMPER) :** Annealed, ½ Hard , Full Hard

**TYPE :** Seamless or ERW (Welded)

**SURFACE FINISH :** Natural , Mirror or Matte

### DESCRIPTION

We are one of the leading manufacturers & exporters of **Small Diameter Precision Tubes**. These Tubes are precisely manufactured using high quality stainless steel in compliance with international quality standards. These Tubes find varied applications in different industries. Available in various sizes and grades, we can also customize these Tubes as per the specific needs of customers.

### STANDARD TUBE SIZE CHART

UNIT OF MEASURE : MM

W.T OD	0.20	0.25	0.30	0.40	0.50	0.55	0.60	0.70	0.80	0.90	1.00	1.25	1.50	2.00	2.50	3.00
1.6	●	●														
1.8	●	●														
2	●	●														
3	●	●	●	●	●	●	●	●	●	●	●					
4	●	●	●	●	●	●	●	●	●	●	●	●	●			
5		●	●	●	●	●	●	●	●	●	●	●	●	●		
6.35		●	●	●	●	●	●	●	●	●	●	●	●	●		
7		●	●	●	●	●	●	●	●	●	●	●	●	●		
8		●	●	●	●	●	●	●	●	●	●	●	●	●		
9.5		●	●	●	●	●	●	●	●	●	●	●	●	●		
10			●	●	●	●	●	●	●	●	●	●	●	●	●	●
12											●	●	●	●	●	●
12.7		●	●	●	●	●	●	●	●	●	●	●	●	●	●	●
14											●	●	●	●	●	●
15											●	●	●	●	●	●
16											●	●	●	●	●	●
19											●	●	●	●	●	●

WE POSSESS MANUFACTURING FACILITIES TO DELIVER VARIOUS OD x ID COMBINATION OF PRECISION TUBING

# WE HAVE THE RIGHT PARTS FOR YOUR PRESSURE GAUGE

## PRESSURE GAUGE ACCESSORIES

AT A GLANCE



SYPHON



SNUBBER



OVER PRESSURE  
PROTECTOR



GAUGE COCK



PRESSURE  
GAUGE SWIVEL  
ADAPTORS



CHAMBER BLOCKS  
FOR DIFFERENTIAL  
PRESSURE GAUGE



OVAL FLANGES FOR  
TRANSMITTERS



COVER PLATE  
FOR LEVEL  
GAUGE



FLUSHING RING



COOLING TOWER



SANITARY DIAPHRAGM  
SEAL

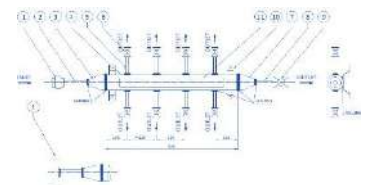

AIR HEADER &  
CONDENSATE  
POT

# INSTRUMENTATION VALVES & MANIFOLDS

## 2 VALVE MANIFOLD

**DESCRIPTION :** ACUTE ENGITECH 2 VALVE MANIFOLDS

Our **2 Valve Manifolds** are designed for connecting system impulse line & transmitters. These manifold consist of two valve configuration which allows for easy isolation, calibration, block and bleed for gauges, pressure switches and static pressure transmitting instruments. The manifolds are rated for pressures as high as 6000 PSI. These valve manifolds combine the functions of a tee, calibration valve, isolation valve and all tubing and fittings into a single compact unit thus reducing number of fittings and space required for installation. These manifolds are used with pressure gauges, switches or transmitters. Different models are available as shown below

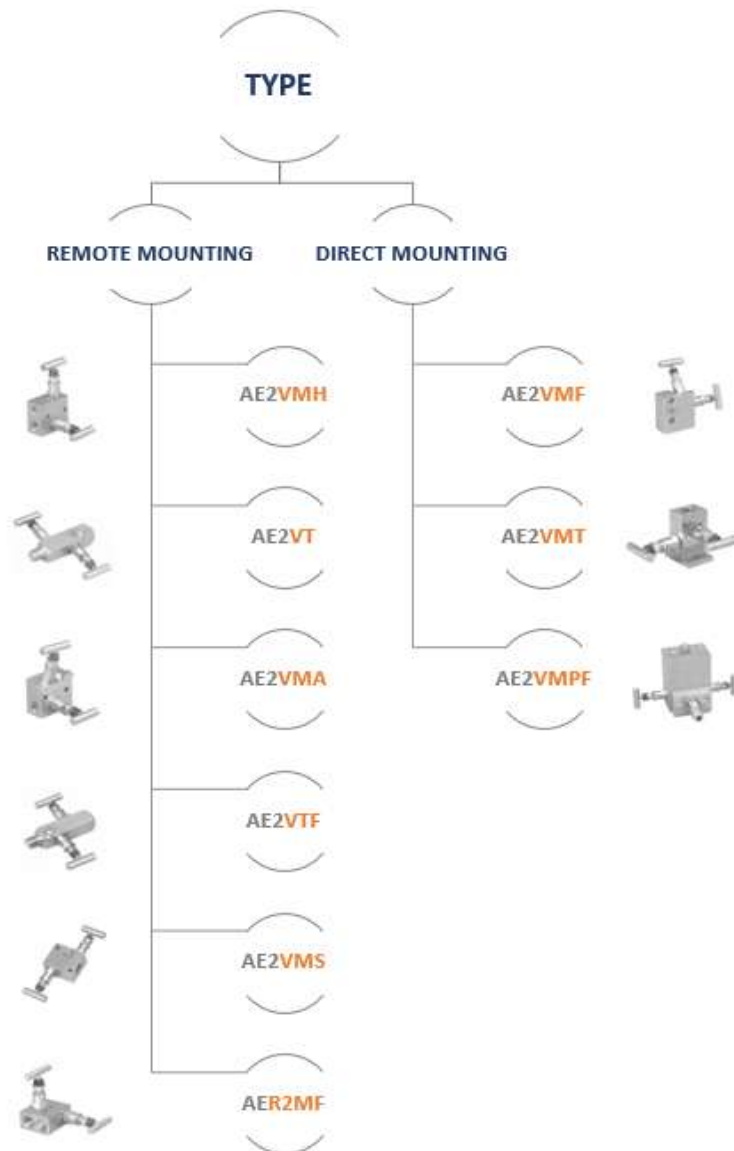

# 3 VALVE MANIFOLD

**DESCRIPTION :** ACUTE ENGITECH 3 VALVE MANIFOLDS

Our **3 Valve Manifolds** are designed for connecting system impulse lines & transmitters. These manifolds consist of pipe to flange or flange to flange connections, with one equalizer valve, two block valves & two vent connections. These manifolds are rugged in construction to withstand high pressures and temperatures. The manifolds are rated for pressures as high as 6000 PSI. These manifolds are generally used in differential pressure application with pressure gauges, pressure switches & pressure transmitters. The different models are available as mentioned below.

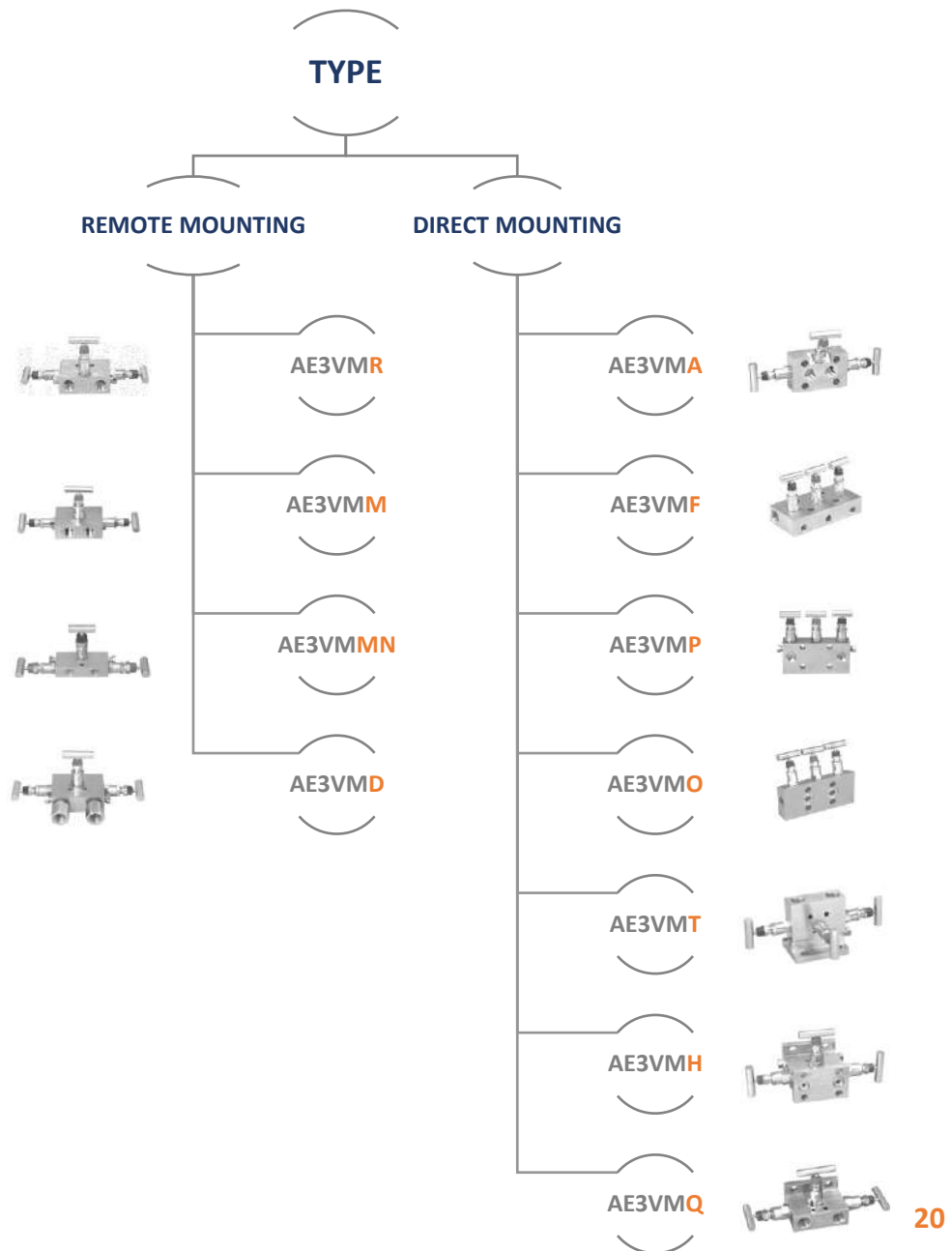

# 5 VALVE MANIFOLD

**DESCRIPTION :** ACUTE ENGITECH 5 VALVE MANIFOLDS

Our **5 Valve Manifolds** are designed for connecting system impulse lines & transmitters. These manifolds consist of pipe to flange or flange to flange connections along with one equalizer valve, two block valves, one bleed valve and two vent connections. These manifolds are rugged in construction to withstand high pressures and temperatures. The manifolds are rated for pressures as high as 6000 PSI.

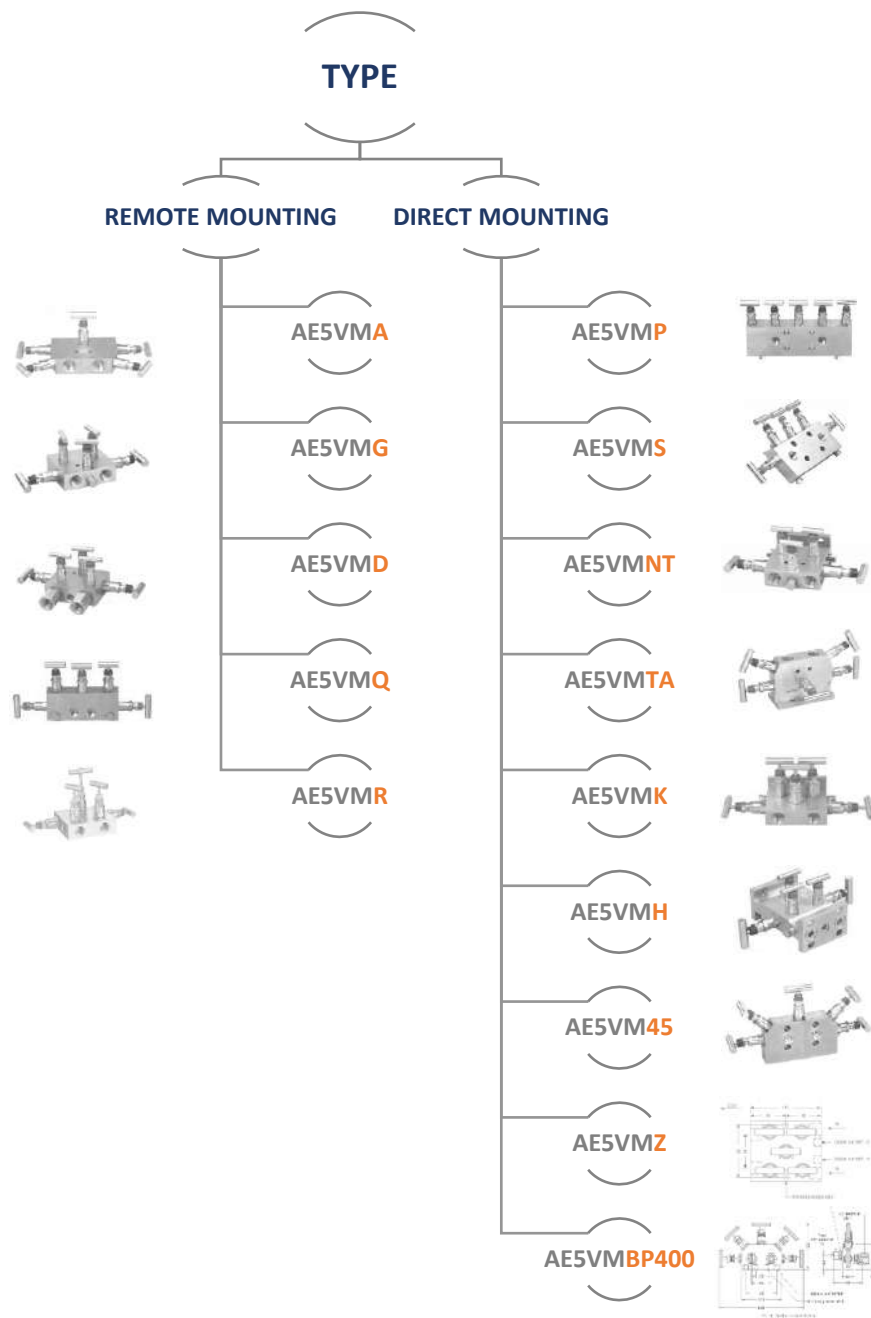

# VALVES CRAFTED WITH PRECISION

PERFORMING UNDER EVERY CONDITION

## OTHER VALVES & MANIFOLDS

AT A GLANCE



NEEDLE VALVE



BLOCK & BLEED VALVE



BLOCK & BLEED  
VALVE WITH  
MINI FLANGE



FLANGED NEEDLE  
VALVE



BALL VALVE



2 VALVE 3 WAY  
MANIFOLD



MULTI-PORT GAUGE  
VALVE



FORGED BODY GAUGE  
VALVE



ROUND BODY  
NEEDLE VALVE &  
GAUGE VALVE



MONOFLANGE VALVE



CHECK VALVE



DOUBLE BLOCK  
& BLEED VALVE



# WE HAVE THE RIGHT PARTS FOR YOUR SENSORS

## TEMPERATURE SENSOR PARTS THERMOWELL



- **GRADE** : Stainless Steel 304, 316, 316 L, 310, 321 , Monel 400, Inconel 600, 800 , Hastelloy C or Brass
- **TYPE** : Threaded , Flanged or Weld-in
- **SHANK TYPE** : Tapered , Straight , Stepped or Built-up
- **FLANGE TYPE** : Raised Face, RTJ or Flat Face
- **BORE** : 7mm, 9mm, 11mm or 13mm
- **U LENGTH** : As Per Requirement
- **END CONNECTIONS** : Instrument Connection (F) x Process Connection (M)
- **THREADING** : As Per Requirement

### DESCRIPTION

---

Our **Thermowells** are available for high pressures, high temperatures and high velocity applications. They are selected on the basis of pressure, temperature, flow, vibration and corrosion service parameters.

It is a thermally conductive socket recommended to protect the delicate instrument sensing element against corrosive effects. It also permits instrument interchange or calibration check without disturbing or closing down the process.

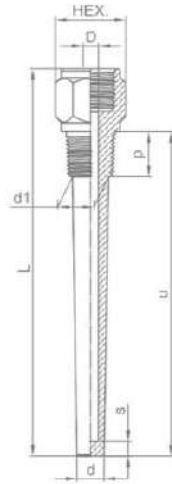

**THREADED-TAPERED**

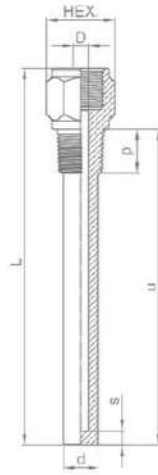

**THREADED-STRAIGHT**

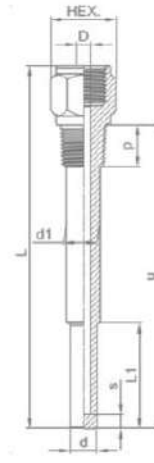

**THREADED-STEPPED**

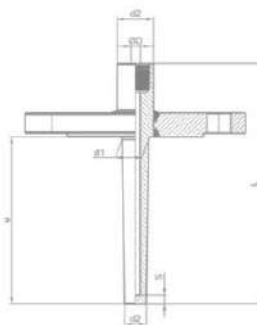

**FLANGED-TAPERED**

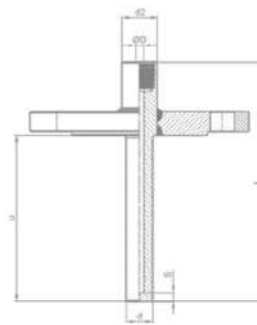

**FLANGED-STRAIGHT**

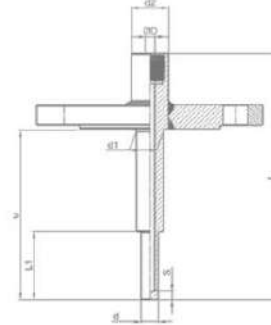

**FLANGED-STEPPED**

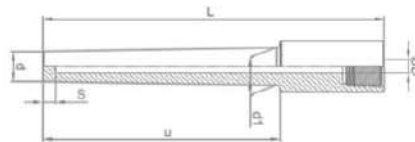

**WELD IN-TAPERED**

### SPECIAL FEATURES

- AVAILABLE WITH PROTECTION SLEEVES
- 100% HYDRO TESTED
- DYE PENETRATING TESTING AVAILABLE ON REQUEST
- AVAILABLE AS PER NACE MR 0175 STANDARDS
- WAKE FREQUENCY CALCULATION TO ASME PTC 19.3-1974 AVAILABLE ON REQUEST
- CAN BE MANUFACTURED AS PER DRAWINGS, TAILOR-MADE AS PER SPECIFIC REQUIREMENT

# NIPPLE UNION NIPPLE CONNECTORS

THREE PIECE CONNECTION



**GRADE :** Stainless Steel 304, 316, 316 L, 310, 321 , Monel 400, Inconel 600, 800 , Hastelloy C or Brass

**END CONNECTION :** M x M

**THREADING :** As Per Requirement

**TOTAL LENGTH :** As Per Requirement

## DESCRIPTION

---

Our **Nipple Union Nipple Connections** are available for high pressures, high temperatures and high velocity applications. It serves as an extension for the sensor. An extension assembly provides extra length, extending the sensor head past insulation and away from heat.

## SPECIAL FEATURES

---

- HYDRO TEST & PROOF TEST AVAILABLE ON REQUEST
- AVAILABLE AS PER NACE MR 0175 STANDARDS
- CAN BE MANUFACTURED AS PER DRAWINGS, TAILOR-MADE AS PER SPECIFIC REQUIREMENT

## FITTINGS

### ADJUSTABLE COMPRESSION FITTINGS



- **GRADE** : Stainless Steel 304, 316, 316 L, 310, 321 , Monel 400, Inconel 600, 800 , Hastelloy C or Brass
- **TYPE** : Single Ferule or Double Ferule
- **TUBE OD SIZE** : 1/16" OD to 1" OD
- **THREADING** : As Per Requirement

#### DESCRIPTION

Our range of **Adjustable Compression Fittings** are available in various grade options. They are used to ensure the correct insertion length into the process and provide some degree of resistance to pressure applications.

We also manufacture **Special Fittings For Diaphragm Seals** using high quality raw material & manufacturing practices. Each & every component is 100% tested for leakages & also marked with the required heat number. We possess facility to manufacture various such critical application fittings as per requirement.

#### SPECIAL FEATURES

- **CLEANED USING ULTRASONIC CLEANING MACHINE**
- **HYDRO TEST & PROOF TEST AVAILABLE ON REQUEST**
- **AVAILABLE AS PER NACE MR 0175 STANDARDS**
- **CAN BE MANUFACTURED AS PER CUSTOM DRAWINGS**

### SPECIAL FITTINGS FOR DIAPHRAGM SEALS



- **GRADE** : Stainless Steel 304, 316, 316 L, 310, 321 , Monel 400, Inconel 600, 800 or Hastelloy C
- **100% TESTED FOR LEAK-TEST**
- **AVAILABLE WITH HEAT NUMBER ETCHING ON EVERY PART**
- **MANUFACTURED AS PER DRAWINGS (TAILOR-MADE AS PER SPECIFIC REQUIREMENT)**

# CONNECTING THE WORLD

## TUBE FITTINGS

### DESCRIPTION : ACUTE ENGITECH TUBE FITTINGS

Our **Tube Fittings** are used for leak proof, torque free seal in different instrumentation & process tubing connections. These products eliminate costly & hazardous leakages. The parts are machined as per international standards to achieve the high quality. The ferrules are hardened & burnished for better swaging. The nuts are silver plated for preventing the seize up on the threads.

### TYPES : ACUTE ENGITECH TUBE FITTINGS

- |  |   |
|--|---|
| <ul style="list-style-type: none"> <li>○ Back Ferrule</li> <li>○ Bulkhead Ferrule Connector</li> <li>○ Bulkhead Locknut For Fractional Tube</li> <li>○ Bulkhead Male Connector</li> <li>○ Bulkhead Reducer Tube</li> <li>○ Bulkhead Union</li> <li>○ Cap Capping-end Of Tube</li> <li>○ Female Adapter Tube To Female Pipe</li> <li>○ Female Branch Tee</li> <li>○ Female Connector</li> <li>○ Female Elbow</li> <li>○ Female Connector Tube To Female ISO Parallel Thread</li> <li>○ Front Ferrule</li> <li>○ Female Run Tee</li> <li>○ Hose To Male Adapter For Fractional Tube</li> <li>○ Hose To Port Connector For Fractional Tube</li> <li>○ Hose To Tube Adapter For Fractional Tube</li> <li>○ Hose To Tube Compression For Fractional Tube</li> <li>○ Male Branch Tee</li> <li>○ Male Adapter Tube To Pipe</li> <li>○ Male Connector</li> </ul> | <ul style="list-style-type: none"> <li>○ Male Connector ISO Parallel Thread</li> <li>○ Male Connector O Seal NPT Tapered Thread</li> <li>○ Male Connector Tube Metric ISO Parallel Thread</li> <li>○ Male Connector Tube Metric ISO Tapered Thread</li> <li>○ Male Elbow</li> <li>○ Male Elbow Tube Metric ISO Tapered Thread</li> <li>○ Male Pipe Weld Elbow</li> <li>○ Male Run Tee</li> <li>○ Nut</li> <li>○ Plug Plugging</li> <li>○ Port Connector</li> <li>○ Reducer Tube Into Snub In</li> <li>○ Tube Insert</li> <li>○ Reducing Union</li> <li>○ Tube To Adapter</li> <li>○ Tube To Bulkhead Union</li> <li>○ Union</li> <li>○ Union Cross</li> <li>○ Union Elbow</li> <li>○ Union Tee</li> </ul> |
|--|---|

## **STANDARD SPECIFICATIONS : ACUTE ENGITECH TUBE FITTINGS**

---

**GRADE :** Stainless Steel 304, 316, 316 L, Carbon Steel, Monel 400 or Brass

**SIZE :** Fractional - 1/16" to 2" & Metric - 3mm to 38mm

### **THREAD SPECIFICATIONS :**

- American National Pipe Thread - (NPT), as per ANSI B1.20.1
- British Standard Pipe Taper Thread - (BSPT), as per BS21, ISO 7/1
- British Standard Pipe Thread - (BSPP), as per BS2779, ISO 228/1
- Metric, as per ISO 261, ANSI B1.13M
- Unified National Pipe Thread - (UN /UNF - SAE), as per ANSI B1.1

**MAXIMUM WORKING TEMPERATURE :** 100°C

**GET IN TOUCH WITH OUR TECHNICAL TEAM FOR FURTHER INFORMATION & ASSISTANCE**

## **SPECIAL FEATURES : ACUTE ENGITECH TUBE FITTINGS**

---

- **CAN BE MANUFACTURED AS PER CUSTOMIZED DRAWINGS, TAILOR-MADE AS PER SPECIFIC REQUIREMENT**
- **HIGH PRESSURE LEAKPROOF JOINTS ARE POSSIBLE WITHOUT USING WELDING, USING ONLY WRENCH OR SPANNERS**
- **SUITABLE FOR HIGH PRESSURE GASES, LIQUIDS & VACUUM**
- **DOUBLE FERRULE DESIGN FOR STRINGENT APPLICATIONS AS IMPULSE, VIBRATION, HIGH PRESSURE GASES & VACUUM CONDITIONS**
- **SILVER PLATING ON NUTS AVAILABLE TO AVOID GALLING**
- **AVAILABLE AS PER SAE STANDARDS**
- **EACH FITTING IS 100% TESTED.**
- **100% MATERIAL TRACEABILITY**

# INDUSTRIAL GLASS THERMOMETER

MACHINE GLASS THERMOMETER • TEMPERATURE THERMOMETER

**BODY CASING :** Aluminum Body Coated With Black Epoxy Powder

**BODY SIZE :** 180mm x 55mm or 250mm x 55mm

**RANGE :** 0-100°C , 0-250°C or 0-400°C

**THERMOMETRIC CAPILLARY :** Glass Prismatic Section

**SENSITIVE STEM :** 12mm OD

**STEM MOC :** Stainless Steel 316

**STEM LENGTH :** 110mm , 130mm , 150mm , 190mm , 230mm or 280mm

**CONNECTION :** ½" NPT M

**WINDOW :** Toughened Glass

**ACCURACY :** Class 1

**FILLING LIQUID :** Ethyl Alcohol (Red)

GET IN TOUCH WITH OUR TECHNICAL TEAM FOR FURTHER INFORMATION & ASSISTANCE



## DESCRIPTION

Our **Industrial Glass Thermometer** are used for temperature measuring & monitoring in industrial applications such as machine building & also in heating, air-conditioning & refrigeration technology. It is notable for its high accuracy & very long service life (since there is no mechanical wear).

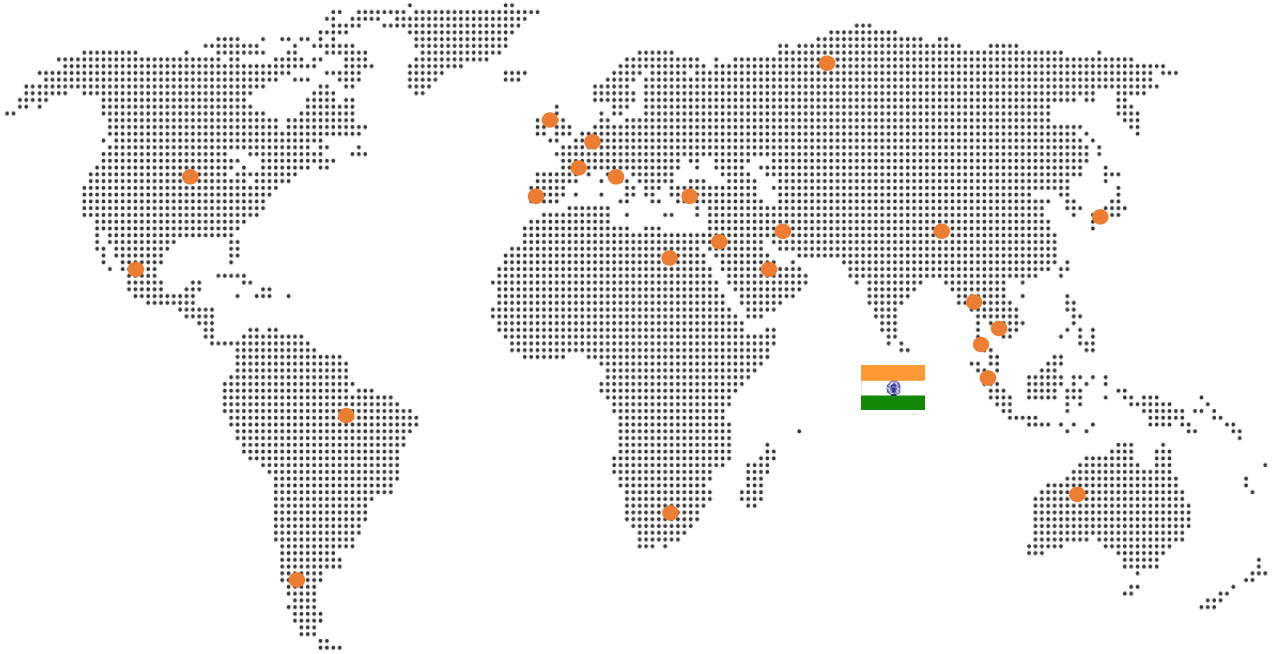

# ACUTE ENGITECH

## UNIT I

Unit No. 15, Shiv Shankar Industrial Estate,  
Bldg. No. 2, Bhut Pada, W. E. Highway,  
Opp. Golden Chariot Hotel, Vasai (E),  
Palghar 401 208, Maharashtra, India.  
**UNIT I : Mon To Sat - 24 Hours**

## UNIT II

Plot No. 78, Apple Industrial Hub, Pelhar  
Phata, Nalasopara (E), Palghar 401 208,  
Maharashtra, India.  
**UNIT II : Mon To Sat - 24 Hours**

## ADMN OFFICE

No. 5, Earth View, 12th Khetwadi Lane,  
Mumbai 400 004,  
Maharashtra India.  
**ADMN OFFICE : Mon To Sat - 9am To 6pm**

**M : • (+91)7506091845 • (+91)9820061819**

**E : [info@acuteengitech.com](mailto:info@acuteengitech.com)**

SCAN HERE



**W : [www.acuteengitech.com](http://www.acuteengitech.com)**